

# SERIES RKS & RKS-V

## RIBBON WIRE

FOR MANUAL AND SEMI-AUTOMATIC BONDERS

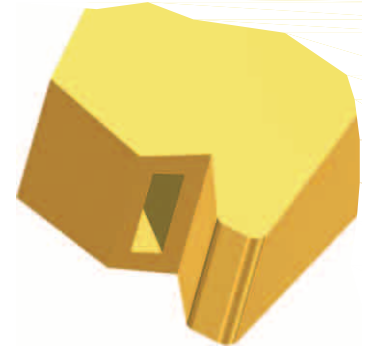
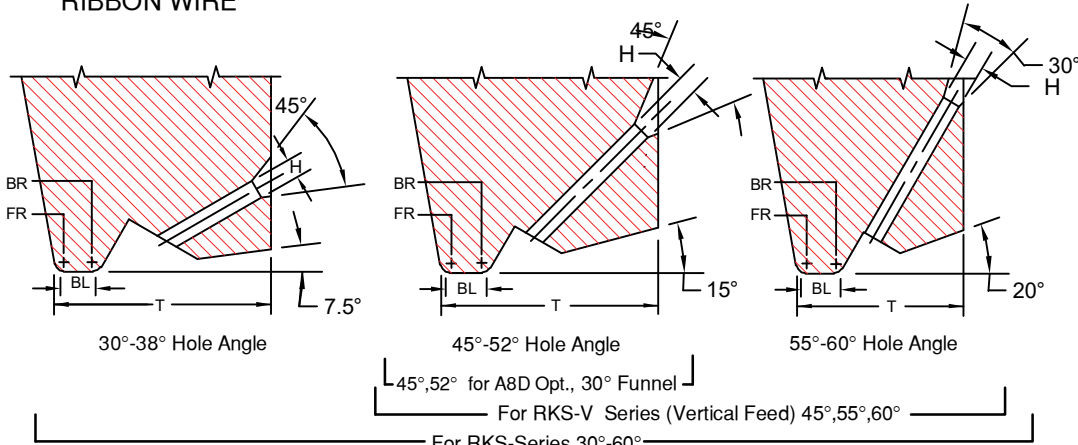

Available Vertical Hole Ø marked with X

	TD		TDF		For Vertical Hole
	in.	mm	in.	mm	
1/16	.0624	1.59	.0460	1.17	
1/16	.0624	1.59	.0590	1.50	X
	.0784	1.99	.0630	1.60	
	.0784	1.99	.0720	1.83	X
3/32	.0937	2.38	.0880	2.24	X
	.1180	3.00	.0985	2.50	
1/8	.1249	3.17	.0937	2.38	
1/8	.1249	3.17	.1180	3.00	

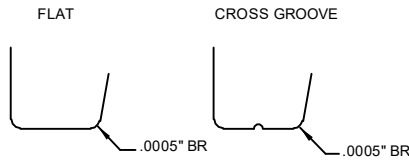

We recommend a .0005" back radius and a cross groove or a flat bond foot when ordering tools for gold wire thermosonic bonding. For more gold wire application information see **Tech Tip**

### RKS-SERIES

Ribbon Width: .0020" through .030"  
Ribbon Thickness: .00025" through .0020"

For large Ø

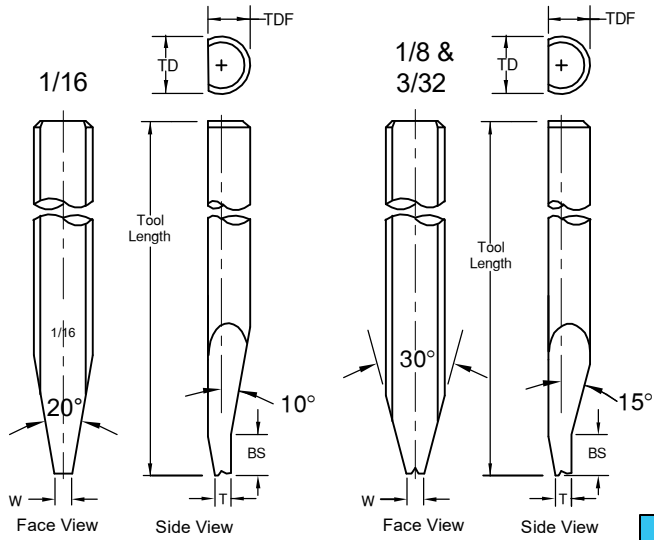

Standard: Ø 1/16, 45° to 52° Hole Angle : BS"=.045" (1.14mm) .  
Supplies only to Standard size Ø1/16, larger tool Ø are different.  
Standard: (BS) supplied unless otherwise specified. See Tool Options #A3

### RKS-V SERIES VERTICAL FEED DEEP ACCESS

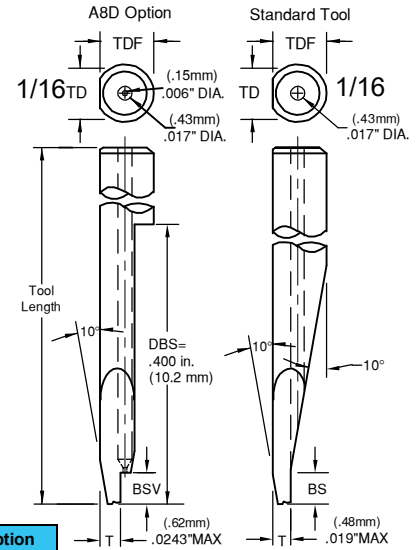

#### A8D Option

Hole Angle	BSV	
	in.	mm
45°	.035	.89
52°	.050	1.27

Standard: Ø1/16 45° to 52° Hole Angle : BS"=.045" (1.14mm)  
Standard: (BS) supplied unless otherwise specified. See Tool Options  
**No Front Angle if T=MAX**

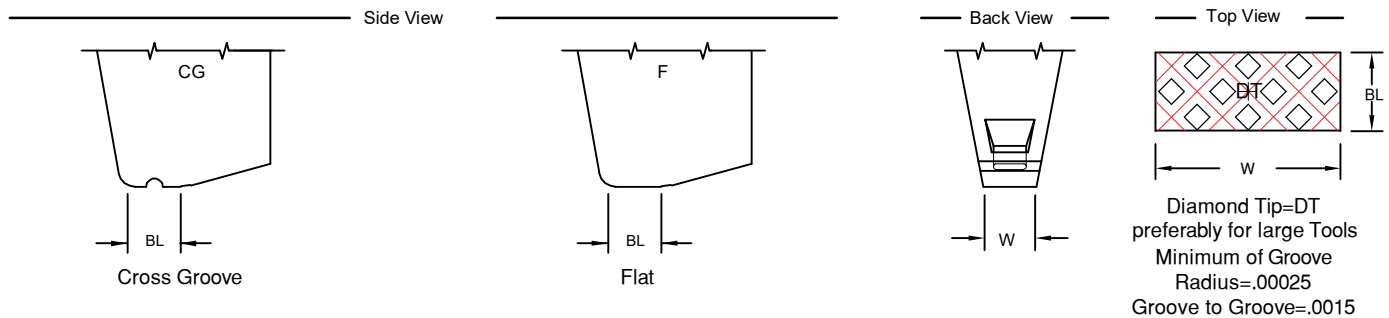

# SERIES RKS & RKS-V

## RIBBON WIRE

### ORDERING INFORMATION

#### RIBBON BONDING WEDGES

#### FOR GOLD AND ALUMINUM WIRE

**SAMPLE PART NUMBER:** M-RKS-O-D-1/16-1-45-CG-.5x5-2-M-\*

**SYMBOL EXPLANATION:** 1 2 3 4 5 6 7 8 9 10 11 12

1. **MATERIAL:**
    - M = Ceramic
    - C = Tungsten Carbide
    - T = Titanium
    - All other: See Material Selection
  2. **SERIES:** RKS
  3. **WIRE FEED:** O = Standard Feed  
V = Vertical Feed
  4. **FRONT/BACK RADIUS:** See Radius Option Chart  
\*For special Radius sizes insert an X Please specify FR/BR
  5. **SHANK DIA.:** Please Specify Diameter
  6. **TOOL LENGTH:** Please Specify Length
  7. **HOLE ANGLE:** for RKS (30°, 38°, 45°, 52°, 55°, 60,°) for RKS-V (45°, 55°, 60,°) for RKS-V with A8D Opt.(45°, 52°)
  - (12) See Tool Option
  - (11) **FOOT FINISH:**
    - M = Matte finish (FR, BR, & Bond Flat)
    - P = Polish finish (FR, BR, & Bond Flat)
    - MP = Polish finish (FR, BR), and Matte finish (Bond Flat)
  - (10) **Bond Length:** See Standard Chart  
Example: BL of .0020 = 2  
Note: We do not recommend bond lengths any larger than .005".
  - (9) **RIBBON SIZE:** See Standard Chart  
Example: .0005 x .005 = .5 x 5  
Thickness x Width
  - (8) **FOOT TYPE:**
    - F = Flat
    - CG = Cross Groove
    - DT = Diamond Tip
- (Please specify Ribbon size)

For special sizes or dimensions insert an (X) in the appropriate position of the part number then specify what (X) equals. Example: M-RKS-O-X-1/16-3/4-45-CG-.5x5-2-M-A7 (X) FR=.0012, BR=.0007

RADIUS OPTION CHART	OPTION LETTER		A	B	C	D	E	F	G	H	I	J	K	L	M	N
	FRONT RADIUS	in.	.0005	.0005	.0010	.0010	.0010	.0015	.0015	.0015	.0015	.0020	.0020	.0020	.0020	.0020
	BACK RADIUS	μ	13	13	25	25	25	38	38	38	38	51	51	51	51	51
	in.	0	.0005	0	.0005	.0010	0	.0005	.0010	.0015	0	.0005	.0010	.0015	.0020	
	μ	0	13	0	13	25	0	13	25	38	0	13	25	38	51	

For Vertical Feed: Tmax. for Dia. 1/16 = .0190 and for A8D: Tmax=.0243, Supplies only to Standard size Ø1/16, larger tool Ø are different.

Size Restrictions for Vertical Feed Tools		
STANDARD		
TD	Maximum Ribbon Width	Maximum "T" Dimension
1/16	.0150	.0190
3/32	.0300	.0210
A8D Option, RW up to .0070		
TD	Maximum Ribbon Width	Maximum "T" Dimension
1/16	.0070	.0243
A8D Option, RW .0080 and larger		
TD	Maximum Ribbon Width	Maximum "T" Dimension
1/16	.0120	.0190
Larger Tool Ø, Ribbon Width and "T" Dimensions available upon request		
RW = Ribbon Width		

STANDARD CHART		RKS		FOR RIBBON THICKNESS: .00025" THROUGH .0020"											
RIBBON WIDTH		RIBBON THICKNESS		BL		T(30°38°)		T(45° 52°)		T(55° 60°)		W			
in.	μ	in.	μ	in.	μ	in.	μ	in.	μ	in.	μ	in.	μ		
<b>Tolerance</b>				±.0002	±5	±.0005	±13	±.0005	±13	±.0005	±13	±.0002	±5		
.0020	51	.00025 through .00125	6.4 32	.0010	25	.0130	330	.0110	279	.0090	229	.0055	140		
				.0015	38	.0130	330	.0110	279	.0090	229				
.0030	76	.00025 through .00125	6.4 32	.0020	51	.0140	356	.0120	305	.0100	254	.0065	165		
				.0025	64	.0140	356	.0120	305	.0100	254				
.0040	102	.00025 through .00125	6.4 32	.0030	76	.0150	381	.0130	330	.0105	267	.0075	191		
				.0010	25	.0150	381	.0130	330	.0110	279				
.0050	127	.00025 through .0020	13 51	.0015	38	.0160	406	.0140	356	.0110	279	.0085	216		
				.0020	51	.0160	406	.0140	356	.0120	305				
.0070	178	.00025 through .0020	13 51	.0025	64	.0170	432	.0150	381	.0120	305	.0125	318		
				.0030	76	.0170	432	.0150	381	.0125	318				
.0100	254	.00025 through .0020	13 51	.0035	89	.0180	457	.0155	394	.0125	318	.0155	394		
				.0040	102	.0180	457	.0155	394	.0130	330				
.0120	305	.00025 through .0020	13 51	.0040	102	.0180	457	.0160	406	.0130	330	.0175	445		
				.0025	64	.0170	432	.0150	381	.0120	305				
.0150	381	.00025 through .0020	13 51	.0030	76	.0170	432	.0155	394	.0125	318	.0205	521		
				.0035	89	.0180	457	.0155	394	.0130	330				
.0200	508	.00025 through .0020	13 51	.0040	102	.0180	457	.0160	406	.0130	330	.0255	648		
				.0025	64	.0170	432	.0150	381	.0120	305				

\*Other sizes available upon request \*All dimensions and tolerances are for reference only  
"T" To be determined according to the size of FR and BR and Hole Bore Length

**Accelonix BV**  
Luchthavenweg 18b • NL-5657 EB •  
Eindhoven • The Netherlands •  
T: +31 40 750 1650 • E: info@accelonix.nl